

ELECTRIC KETTLE

Model No: 101167

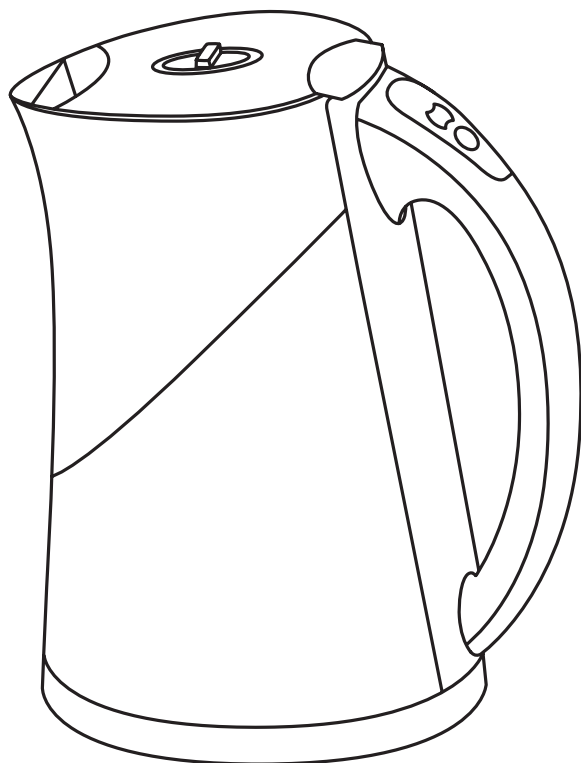

INSTRUCTION MANUAL

READ THESE OPERATING INSTRUCTIONS CAREFULLY
BEFORE USING THE MACHINE AND STORE IN A SAFE PLACE

FOR HOUSEHOLD USE ONLY



Ideas with Passion



IMPORTANT SAFEGUARDS

When using electrical appliances, basic safety precautions should always be followed to reduce the risk of fire, electrical shock and / or personal injury.

- ✓ Always ensure your hands are dry before handling the plug or switching on the kettle.
- ✓ Always use the kettle on a secure, dry and level surface.
- ✓ Always store the excess portion of the power cord in the the base unit.
- ✓ Always carry out regular checks of the power cord to ensure no damage is evident. Should there be any signs that the cord is damaged in the slightest, the entire appliance should be returned.
- ✓ Always return the kettle after a malfunction, or if it has been damaged in any manner.
- ✓ Always exercise caution in carrying the kettle when it is full of boiling water and when pouring.
- ✓ Always avoid excessive tilting of the kettle after filling.
- ✓ Always beware of steam being emitted from the spout or lid especially during refilling.
- ✓ Always unplug the kettle from the socket after use and before cleaning.
- ✓ Always allow the kettle to cool before cleaning and storing.
- ✗ Never touch hot surfaces.
- ✗ Never use this kettle outdoors.
- ✗ Never use this appliance for anything other than its intended use. This kettle is for household use only.
- ✗ Never use the kettle to heat anything other than water.
- ✗ Never immerse any part of the kettle, power base or cord and plug in water or any other liquid to protect against electrical hazards.
- ✗ Never use harsh, abrasive or caustic cleaners to clean the kettle.
- ✗ Never allow children to use this kettle. Close supervision is necessary when the kettle is used near children.
- ✗ Never leave the kettle unattended when in use.
- ✗ Never open the lid during the boiling cycle.
- ✗ Never fill above the MAX mark as hot water may be ejected.
- ✗ Never allow the kettle to boil dry. If the kettle does boil dry, allow it to cool, unplug it and refill it with cold water.
- ✗ Never fill the kettle when it is positioned on the power base.
- ✗ Never place the kettle on or near a hot gas or electric burner or where it could touch a heated oven or microwave oven.
- ✗ Never use a power base other than the one supplied with the kettle.
- ✗ Never insert any object into any slots or holes of the kettle.
- ✗ Never operate the kettle with a damaged cord or plug or after a malfunction or if it has been dropped or damaged in any manner.

Caution: This appliance generates heat during use. Adequate precautions must be taken to prevent the risk of burns, scalds, fires or other damage to persons or property caused by touching the exterior while in use or during cooling.

SHORT CORD INSTRUCTIONS

A short power cord is provided to reduce the risk resulting from entanglement or tripping over a longer cord. Extension cords are available and may be used if care is exercised in their use. If an extension cord is used (1) the marked electrical rating of the extension cord should be at least as great as the electrical rating of the appliance, and (2) the longer cord should be arranged so that it will not drape over the countertop or table top where it can be pulled on by children or tripped over unintentionally. The electrical rating of the appliance is listed on the bottom of the unit. If the appliance is of the grounded type, the extension cord should be a grounded type 3-wire cord. This appliance has a polarized plug. One blade is wider than the other. As a safety feature, this plug will fit in a polarized outlet only one way. If the plug does not fit, contact a qualified electrician. Do not attempt to tamper with or alter this safety feature.

CONTACT INFORMATION

Please read the entire instruction manual thoroughly before operating your kettle. If you have questions after reading the enclosed information, please contact Saeco Customer Service for assistance.

Saeco USA
7905 Cochran Rd. - Suite 100
Glenwillow, OH 44139
www.saeco-usa.com

Phone: 1.800.933.7876
Fax: 1.440.542.9173
Email: info@saeco-usa.com

FEATURES

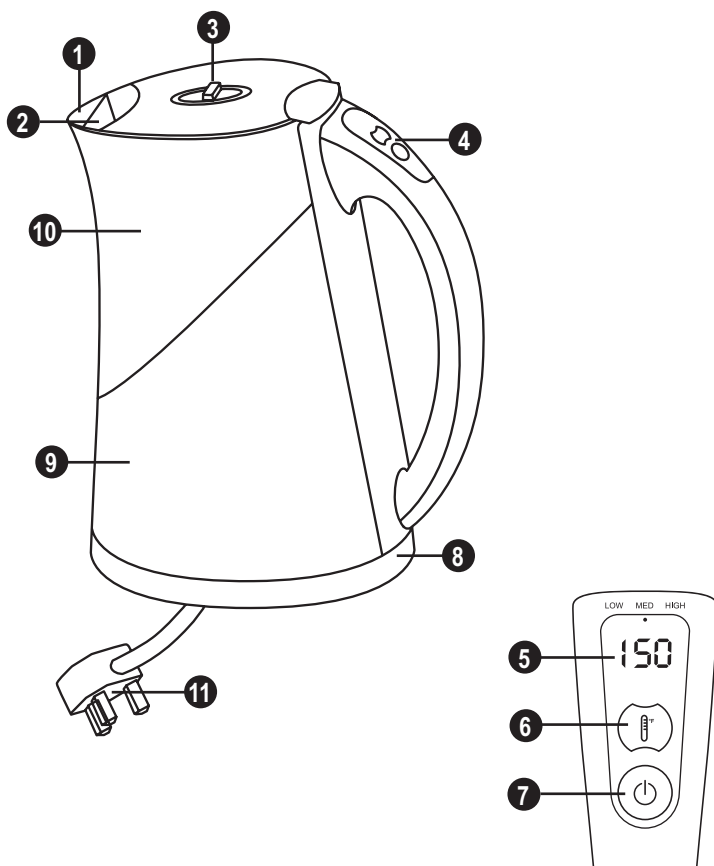

1. Spout
2. Water Filter
3. Lid Release Switch
4. Control Panel
5. Digital Display
6. Temperature / Keep Warm Button
7. Boil Button
8. Power Base
9. Metal Lining
10. Water Carafe
11. Power Cord

BEFORE USING YOUR KETTLE

1. Remove the kettle from the packaging and position it on a dry, level, secure work surface away from the edge.
2. Before connecting it to a power source, make sure that your power voltage is the same as the one indicated on the base of the kettle. Connect the cord to a suitable power socket. Make sure that the power cord does not overhang the work surface.
3. Remove the kettle from the power base and open the lid using the lid release switch. Fill the kettle to the MAX mark. Make sure the kettle is not over-filled. Always compare the water level against the water tank markings with the kettle positioned on the power base.
4. Close the lid and place the kettle back onto the power base.
5. Press the boil button.

Allow the kettle to boil the water and then discard it. Repeat this procedure twice. This will remove any residue left from the manufacturing process. Remove and rinse the filter before use. See "To Clean the Filter" section.

USING YOUR KETTLE

Conventional Boiling

1. With the kettle switched off, plug the power cord into a suitable power socket. The kettle will beep and the display will show LOW.
2. Remove the kettle from the power base before filling it with water. Open the lid using the lid release switch. Do not fill the kettle through the spout.
3. Fill the kettle with water and position it back on the power base. Make sure that the water level doesn't exceed the MAX marking on the water carafe.

Warning: If this kettle is filled above the maximum level mark, hot water may be ejected from the spout during boiling.

4. Close the lid and press the boil button. The boil button will illuminate and the water carafe will illuminate blue and start to boil. The water carafe illumination will change from blue through to red as the kettle boils the water. The display will show the temperature of the water during and after heating. It will start off displaying LOW but as the temperature of the water rises above 100°F, it will display the actual water temperature.
5. When the water reaches boiling point, the kettle will beep, automatically turn off and the water carafe illumination will turn off.
6. **To cancel or interrupt boiling**, either press the boil button or lift the kettle off of the power base.

USING YOUR KETTLE

Keep Warm Mode

The temperature / keep warm button can be used to select one of three temperatures 100°F, 150°F and 200°F. The keep warm mode will maintain the selected water temperature for up to 2 hours.

1. Press the temperature / keep warm button until the dot (•) on the display is lined up with the desired temperature.

Each temperature setting has a different color illumination of the water carafe.

Selected Temperature	Water Carafe Illumination
LOW	Light Blue
MED	Dark Blue - Pink
HIGH	Red

2. The temperature / keep warm button will illuminate, the water carafe will illuminate and the kettle will slowly heat the water to the selected temperature. Note that the water will not be heated as quickly as when the boil function is used. The display will show the actual water temperature once it rises above 100°F. It is normal for the displayed temperature to fluctuate a few degrees on either side of the set temperature.
3. Once the water has been heated to the selected temperature, the kettle will enter keep warm mode and will occasionally switch on and off in order to maintain the selected temperature. The water carafe illumination will remain on.
4. **To cancel the keep warm mode**, either press the temperature / keep warm button or lift the kettle off of the power base.

USING YOUR KETTLE

Boil Then Keep Warm Mode

The kettle can be set to boil the water and then keep it at the selected temperature for up to two hours.

1. Press the temperature / keep warm button until the dot (•) on the display is lined up with the desired temperature.
2. Press the temperature / keep warm button and boil button at the same time. Both buttons and the water carafe will illuminate. The kettle will then bring the water to a boil and the water carafe illumination will change from blue to red.
3. When the kettle has boiled, it will beep, automatically switch off and the boil button illumination and water carafe illumination will go out. The temperature of the water will then start to drop until it reaches the temperature set during step 1. This may take some time. The kettle will then enter keep warm mode and will occasionally switch on and off to maintain the water at the selected temperature.

The display will show the temperature of the water during boiling and the keep warm period. Note that it is normal for the displayed temperature to fluctuate a few degrees either side of the set temperature.

If a low temperature is selected, the kettle may not have sufficient time to cool down to this temperature during the 2 hour keep warm period.

4. **To cancel the boil then keep warm mode**, either press the boil button or lift the kettle off of the power base

CLEANING

Warning: Always unplug the kettle from the socket and allow it to cool completely before cleaning or descaling it.

1. Clean the exterior surface of the kettle with a damp cloth and then polish it with a soft dry cloth. Do not use steel wool pads or harsh/abrasive cleaners, which may damage the body.
2. Do not immerse the power base or power cord in water or liquid of any kind.
3. This kettle features a concealed heating element which means it never comes into contact with the water inside the kettle. This hygienic design not only makes cleaning the inside of the kettle much easier, it also keeps cleaning to a minimum.
4. Although the kettle is designed for the element to remain scale free, in hard water areas, scale may still build up on the base. Therefore, it is very important that you descale regularly using a proprietary descaler. Not doing so will spoil the appearance and efficiency of the kettle and could result in failure of the appliance. Not descaling as advised could void your warranty.

Use a proprietary descaling product and always follow the manufacturer's instructions carefully when descaling the kettle.

Cleaning the Filter

Before removing or cleaning the filter, turn the kettle off. Unplug the power base, empty any water from the kettle and allow it to cool completely.

To Remove the Filter

- Open the lid using the lid release switch.
- Take hold of the top of the filter and pull it upwards, paying particular attention to how the filter is fitted. The filter should slide out of the grooves easily without having to use excessive force.

To Clean the Filter

- Rinse filter under a tap while brushing with a soft brush. In hard water areas it may be necessary to descale with a proprietary descaling agent. Rinse thoroughly to remove any remaining descaling agent.

To Reinsert the Filter

- Make sure that your hands are clean and free from soap or anything which might contaminate the water.
- Holding the top of the filter, slide it into the grooves inside the spout until it clicks into position.

Warning: Do not operate this kettle without the filter fitted into place.

